

The Firs, Rosebank





Unlock the potential of space

A space is more than its surface area and walls; it's a canvas for human experience. More than structure and aesthetics, spaces enable connections and inspire. Spaces engage us; they are sensory and invite interaction. They draw us in and influence our wellbeing. Spaces hold history. They can be imagined and reimaged. At Investec Property, we don't just look at how a space is, but at how it can be and what it can bring to people's lives.

We see the value it holds and the opportunities it presents.

We see the potential of space.

Location

We get the fundamentals right. Everything we've achieved is built on the understanding that location is strategic. Once we have the right location and understand the context of the space, we begin to imagine how we can repurpose it to its full potential. Then, we create a sought-after environment that both complements and adds to its surrounds. It's how we develop quality assets that hold value and deliver attractive long-term returns.

Relation

We engage with our stakeholders and tenants to understand their requirements now, and we anticipate how these might change in future. From this knowledge, we evolve spaces so that they work optimally for our occupiers. We also prioritise the preservation of sound covenants to ensure low vacancies. By valuing and investing in human connections, we maximise long-term wealth creation and extract value for our stakeholders.

Innovation

We innovate to realise the potential of space and collaborate with new partners, shifting the emphasis from assets to experiences that meet our clients' needs.

The Firs, Rosebank

13 089m² of prime office space and retail

Vacancy	Office space
535m ²	First floor
456m ²	First floor
580m ²	Third floor
Gross rental	R190/m²

Backup power and water

Exclusive tenant lounge and outdoor patio

Restaurant Piazza

Immediate Gautrain Station access

External signage available





Overview

The Firs, situated in Johannesburg's northern suburb of Rosebank is a landmark in the bustling and cosmopolitan node of the 'mixed-use' Rosebank precinct. The Firs has undergone an impressive redevelopment and is now an enhanced multiuse complex, living up to its promise of unique work, shop and dine experiences. The vision was to provide a lifestyleorientated yet intimate selection of retail outlets complemented by distinctive high-end dining establishments.

The restaurant piazza offers a perfect combination of tranquility and social buzz, with exclusivity remaining key, catering specifically to the aspirations and desires of the modern patron. The imposing triple-volume office lobby with collaborative seating areas and outdoor patio complement the 8200m² of A-grade offices with easy access to underground parking.

This prime location is well served for commuting by public transport with Rosebank Gautrain station walking distance from the centre, which is on the Bus Rapid Transport Network. The M1 highway interchange is also proximate, providing easy connections to other areas.

Locality map



First floor

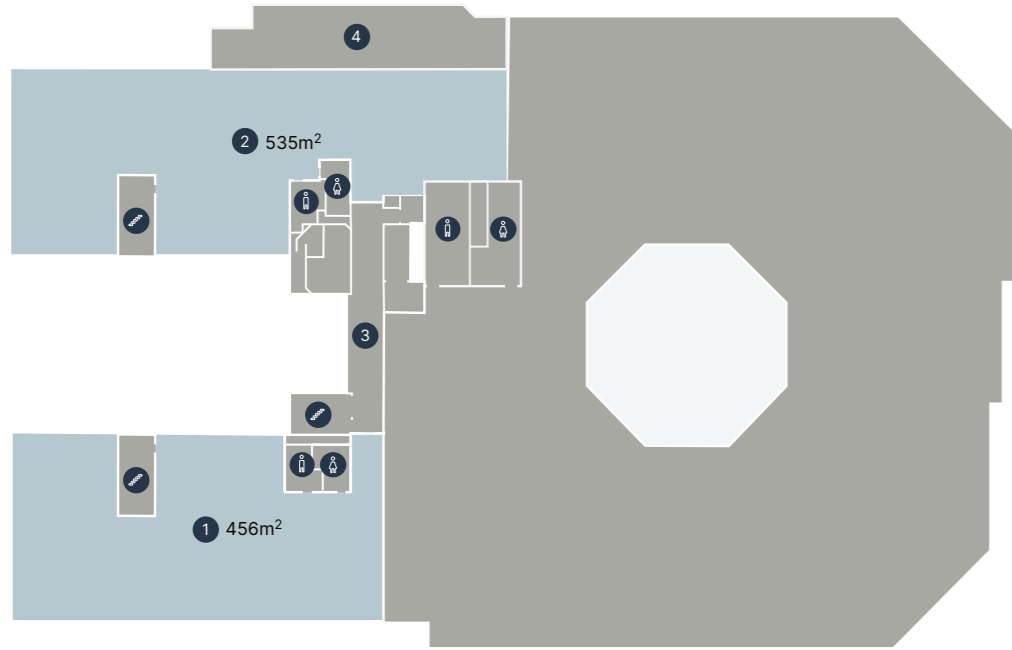

Key

- 1 Vacant
- 2 Vacant
- 3 Common area
- 4 Terrace
- 5 Canteen

Third floor

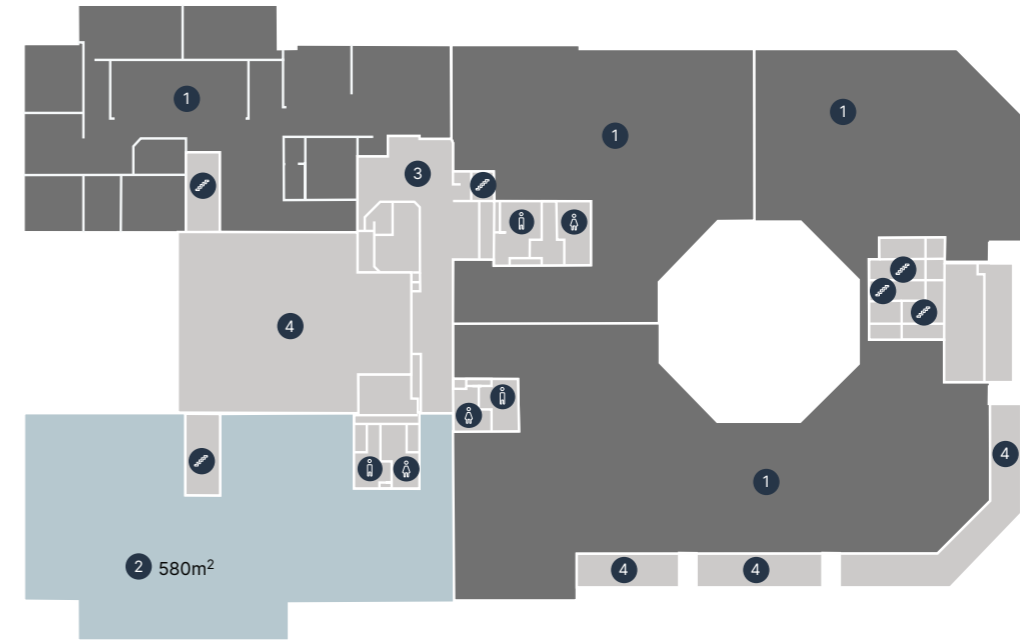









Key

- 1 Tenanted
- 2 Vacant
- 3 Lobby area
- 4 Terrace

CONCEPTUAL LAYOUT



TYPICAL OFFICE GENERAL ARRANGEMENT

-  RECEPTION
-  MEETING ROOM
-  FOCUS SPACES
-  STORE ROOM
-  BREAKAWAY
-  ENCLOSED OFFICES
-  OPEN PLAN DESKS (30 PAX)
-  COLLABORATION AREA
-  PRINT STATION



TENANT LOUNGE



OUTDOOR DECK



PIAZZA STREET LEVEL



PIAZZA DRONE



Contact

Simon King

Asset Manager

083 318 1254

simon.king@investec.co.za

Dennis Helyar

Leasing

083 604 0535

dennis.helyar@investec.co.za

investecpropertyfund.com



This brochure is issued by Investec Property (Pty) Ltd, as manager of Investec Property Fund Limited. The information contained in this document has not been independently verified. Accordingly, no representation or warranty express or implied, is being made or given as to the accuracy or completeness of the information or opinions and no responsibility is accepted for any such information or opinions. The information contained in this document is subject to completion, revision, verification and amendment without notice. This document is confidential and may not be reproduced (in whole or in part) or be disclosed to any third party without the prior written consent of Investec Property Proprietary Limited. Investec Property (Pty) Ltd, a company incorporated in South Africa, registration number 1947/025753/07. A member of the Investec Group and manager of Investec Property Fund Ltd. Investec Property Fund Limited, a company incorporated in South Africa with registration number 2008/011366/06, is a South African Real Estate Investment Trust (REIT), which listed on the Johannesburg Stock Exchange (JSE) in the Real Estate Holdings and Development sector. It is not collective investment scheme in terms of the Collective Investment Schemes Control Act No. 45 of 2002.